

Jonathan Hunt

— LETTING AGENCY —

20 High Street Ware SG12 9BX

Tel: 01920 411090

8 High Street Buntingford SG9 9AG

Tel: 01763 272727

info@jonathan-hunt.co.uk

www.jonathanhunt.co.uk



10 High Oak House, Collett Road, Ware, Hertfordshire, SG12 7LY

£1,195 Per Month

10 High Oak House, Collett Road, Ware, Hertfordshire, SG12 7LY

JONATHAN HUNT LETTINGS are pleased to offer this ground floor one double bedroom apartment located within this small private development of just 11 properties. The property features a fully fitted Kitchen with integrated fridge/freezer washer dryer and dishwasher, double glazed windows, fitted wardrobe and allocated parking. Available from 13/03/2026

REFERENCES - Please only enquiry if you pass the reference criteria
- Collective Gross Income: Minimum multiple of 30 times the monthly rental
- NO CCJ's, IVA's or history of bad credit
- Positive landlord reference (if applicable)

<https://tenanthelp.goodlord.co/s/article/What-is-Goodlord-referencing>

ALL PROPERTIES HAVE A NO PET AND NO SMOKING POLICY UNLESS OTHERWISE ADVERTISED
Please note there are no tenant fees and the security deposit is capped to the equivalent of 5 weeks rent.

Council Tax Band B
Local Authority - East Hertfordshire



ENTRANCE

LIVING 15'7" x 18'3" (4.76 x 5.57)

Dual aspect double glazed windows to side and rear with doors to private garden.

KITCHEN

BEDROOM 11'6" x 9'11" (3.53 x 3.03)

Two double glazed windows to side

BATHROOM

Three piece suite, tiled flooring

EXTERIOR

NOTE

The main photo is a computer generated image. All apartments are fitted with wood flooring to hallways and reception areas with carpets to the bedrooms.





Ground Floor

Approx. 41.3 sq. metres (444.2 sq. feet)

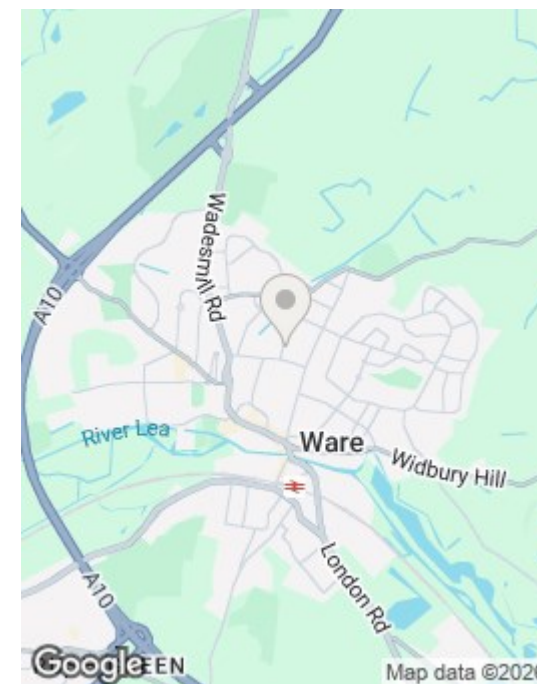
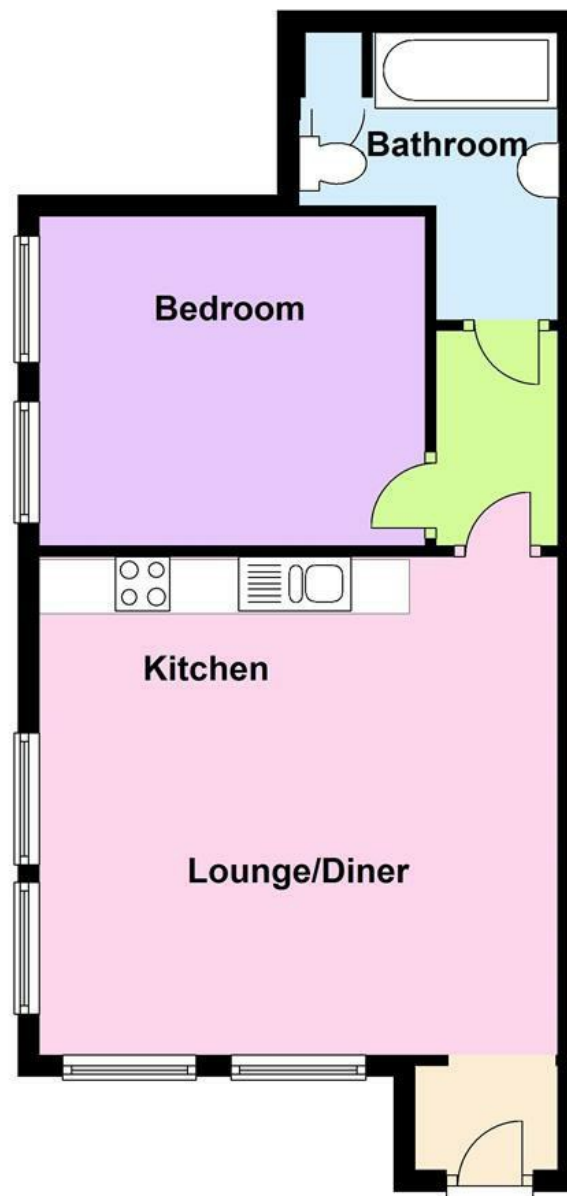

Total area: approx. 41.3 sq. metres(444.2 sq. feet)

Energy Efficiency Rating		Environmental Impact (CO ₂) Rating	
	Potential		Potential
Very energy efficient - lower running costs		Very environmentally friendly - lower CO ₂ emissions	
(92 plus) A		(92 plus) A	
(81-91) B		(81-91) B	
(69-80) C		(69-80) C	
(55-68) D		(55-68) D	
(39-54) E		(39-54) E	
(21-38) F		(21-38) F	
(1-20) G		(1-20) G	
Not energy efficient - higher running costs		Not environmentally friendly - higher CO ₂ emissions	
England & Wales		England & Wales	
EU Directive 2002/91/EC		EU Directive 2002/91/EC	